

© 2020 Thames & Kosmos, LLC., 89 Ship St., Providence, RI, 02903 USA

Manufacturer: © Franckh-Kosmos Verlags-GmbH & Co. KG, Pflizerstr. 5-7, 70184 Stuttgart, Germany
+49 (0) 711 2191-0; www.kosmos.de @Thames & Kosmos is a registered trademark of Thames
& Kosmos, LLC. Protected by law. All rights reserved. Right to technical alterations reserved.
Customer Service: 1-800-587-2872; www.thamesandkosmos.com
Customer Service UK: 01580 212000; www.thamesandkosmos.co.uk

 THAMES & KOSMOS

WARNING — THIS
SET CONTAINS CHEMICALS
THAT MAY BE HARMFUL IF
MISUSED. READ CAUTIONS
ON INDIVIDUAL CONTAINERS
CAREFULLY. NOT TO BE
USED BY CHILDREN EXCEPT
UNDER ADULT SUPERVISION.

WARNING. Not
suitable for
children under 3
years. Choking
hazard — small
parts may be
swallowed or inhaled. Keep
the packaging and instructions
as they contain important
information.



**Ooze
Labs**  

Mix Your Own
**Glow-in-the-Dark
Slime**

Ooze Labs: Glow-in-the-Dark Slime
No. 575005 KIN 1617484
Made in Taiwan

575005-02-161220



8

4

1. SETTING UP THE OOZE TUBE

CONTENTS

Test tube, lid, packet of slime powder (6.5-7.5 g (0.22-0.26 oz.), No. 717691), cardboard strip

YOU WILL ALSO NEED

Permanent marker, water, scissors, optional: stirring stick

HERE'S HOW

1. Remove the slime powder packet and piece of cardboard from the test tube.
2. Use the cardboard strip to make a test tube holder by rolling it into a circular tube and fitting it into the cap. Place the test tube into the holder.

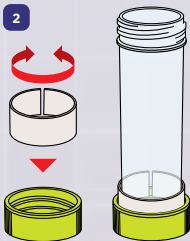
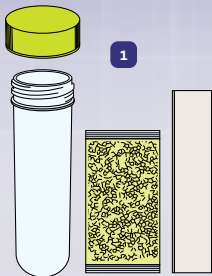

2. MIXING THE SLIME

3. Fill the test tube with 75 ml of water. To measure this, use the test tube guide printed here to make a mark on the test tube. Fill the test tube up to the line with water. (You can also just eyeball it.)

3



4. Open the packet of powder using a pair of scissors. Do not use your teeth. Be careful not to get any of the powder in your eyes or mouth.

4



9 cm
(75 ml)

TEST TUBE FILLING GUIDE

3. LET IT GLOW

5. Pour all of the powder slowly into the tube and avoid creating airborne dust.
6. Optional: Use a disposable stirring stick to mix the powder into the water.
7. Close the test tube with the lid and shake it for 30 seconds. Let the contents sit, shaking the tube every few minutes, until they have solidified. This takes about 15–20 minutes. Afterward, you can open up the test tube and have fun experimenting with the slime.
8. Place the slime under a light source, like a light bulb, for a few minutes. Then bring the slime into a dark room. What happens?

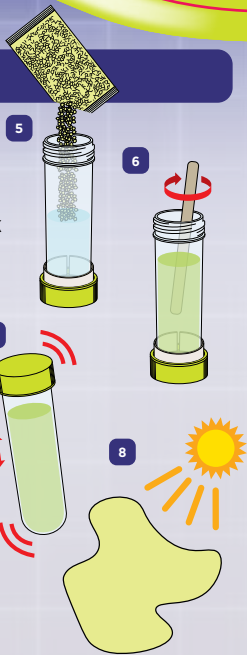

WHAT'S HAPPENING?

A solid substance that lights up when exposed to energy, like light or electricity, is called a **phosphor**. A phosphor can be **phosphorescent**, which stays glowing after the energy source is removed, or **fluorescent**, which only glows while the energy is present and for a brief moment after. The reason that a phosphorescent material glows after the light source has been removed is because the molecules in the material store the incoming light energy and then gradually emit it in the form of light. Phosphorescent materials are used in warning signs that must be visible in the dark, and in alarm clocks meant to be visible in a dark bedroom. There are even winter coats that come with a glowing element, so the wearers are easier to see in the dark!



THE DISCOVERY OF PHOSPHORUS

The chemical element **phosphorus** was discovered with the help of the light that it emits when exposed to air. Over 300 years ago, the German alchemist Henning Brand attempted to make a philosopher's stone (which was supposed to grant eternal life and wealth) out of urine. To do this, he heated a large quantity of urine for a long while until all the water evaporated, and then heated what remained in an enclosed glass flask. When he opened the cooled flask, it suddenly emitted bright light. Brand called the light-generating substance phosphorus, after the Greek word *phosphoros*, meaning light-bearer. Today we know that the process of heating urine converted naturally-occurring phosphorus compounds into so-called white phosphorous, which emits light photons when it comes into contact with oxygen in the air.

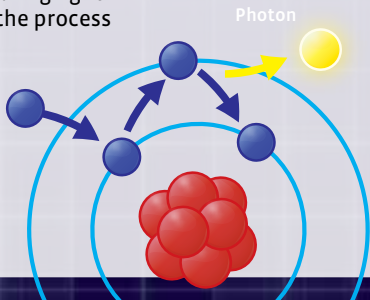

INFORMATION FOR PARENTS AND ADULTS

Dear Parents,

With this kit, you will be helping your child experiment with glow-in-the-dark slime. We are asking you to read these instructions together with your child, follow them and keep them for reference. Only carry out the experiments listed in the instructions. Do not allow the slime powder and the finished slime to come into contact with the eyes or mouth. Please remind your child to wash his or her hands thoroughly after the experiments and after handling the slime. This set is for use only by children over 6 years. For use under adult supervision. Therefore store it out of reach of children under 6 years old and animals. This includes the slime powder, the finished slime and the materials in the set.

Look for a good place to do the experiments. The area surrounding the experiment should be kept clear of any obstructions and away from the storage of food. Use a solid table with a top that can easily be cleaned. The working area should be cleaned up immediately after carrying out the activity. Also clean all equipment after use and thoroughly wash your hands. The slime powder should be used up (completely) during the course of the experiment. Open the packet of slime powder with scissors — never with your teeth. While experimenting, please be careful not to create dust of the powder. Do not eat or drink in the experimental area and while doing the experiments. The slime may cause stains that can't be washed out of clothing. Therefore wear suitable clothes that can get stained and keep the materials away from table clothes, curtains, and carpets. Store the finished slime in the test tube to prevent it from drying out and to prevent it from sticking on the surface. Dispose off all materials in this kit in the household trash and the slime when it gets dirty, liquefies, or dries out.

We hope you and your child have a lot of fun with the glow-in-the-dark slime!

4TH EDITION

© 2020 THAMES & KOSMOS, LLC, PROVIDENCE, RI, USA
© THAMES & KOSMOS IS A REGISTERED TRADEMARK OF THAMES & KOSMOS, LLC.
PROTECTED BY LAW. ALL RIGHTS RESERVED. WE RESERVE THE RIGHT TO MAKE TECHNICAL CHANGES.

THAMES & KOSMOS, 89 SHIP ST., PROVIDENCE, RI,
02903, USA
1-800-587-2872 WWW.THAMESANDKOSMOS.COM
FRANCKH-KOSMOS VERLAGS-GMBH & CO. KG, PFIZERSTR.
5-7, 70184 STUTTGART, GERMANY
+49 (0) 711 2191-0 WWW.KOSMOS.DE
PRINTED IN TAIWAN / IMPRIMÉ EN TAIWAN

SAFETY INFORMATION

Information about the Included Slime Powder

Glow-in-the-dark slime powder, 6.5-7.5 g (0.22-0.26 oz.)

Main ingredients: Locust bean gum, guar gum, silica, glow-in-the-dark color pigment

Do not get in eyes, into the mouth or on clothing.

Wash hands thoroughly after handling.

Do not ingest. Avoid breathing dust. Use only as instructed.

Keep slime powder out of reach of small children and animals.

Store the slime locked up.

Use the materials carefully, as they may stick to or stain fabric, wood, carpet, or other materials. Clean with water.

As we have omitted hazardous substances from this slime, it will disintegrate after a few days; the mixture will become watery.

First Aid Information

If any powder or finished slime gets into the eyes: Wash out eye with plenty of water, holding eye open, if necessary. Seek immediate medical advice.

If swallowed: Wash out mouth with water, drink some fresh water. Do not induce vomiting. Seek immediate medical advice.

In case of doubt, seek medical advice without delay. Take the slime or powder and its packet / this manual with you.

WARNING!

Not suitable for children under 3 years.

Choking hazard — small parts may be swallowed or inhaled.

Keep packaging and instructions, as they contain important information.